

**NOTES:**

1. Dimensions are in inches & [mm].
2. Triangle on lid denotes Pin 1.
3. Pins: Alloy 510 phosphor bronze plated with matte tin (150-300u") over nickel (500u" max.) underplate.
4. Epoxy-sealed & ultrasonically welded non-hermetic package.
5. Creepage distance between I/O pin pads: 0.050 inches.
6. The exposed substrate contains BeO. Do not crush, machine or subject to temperatures in excess of 850° C to avoid generating toxic fumes.

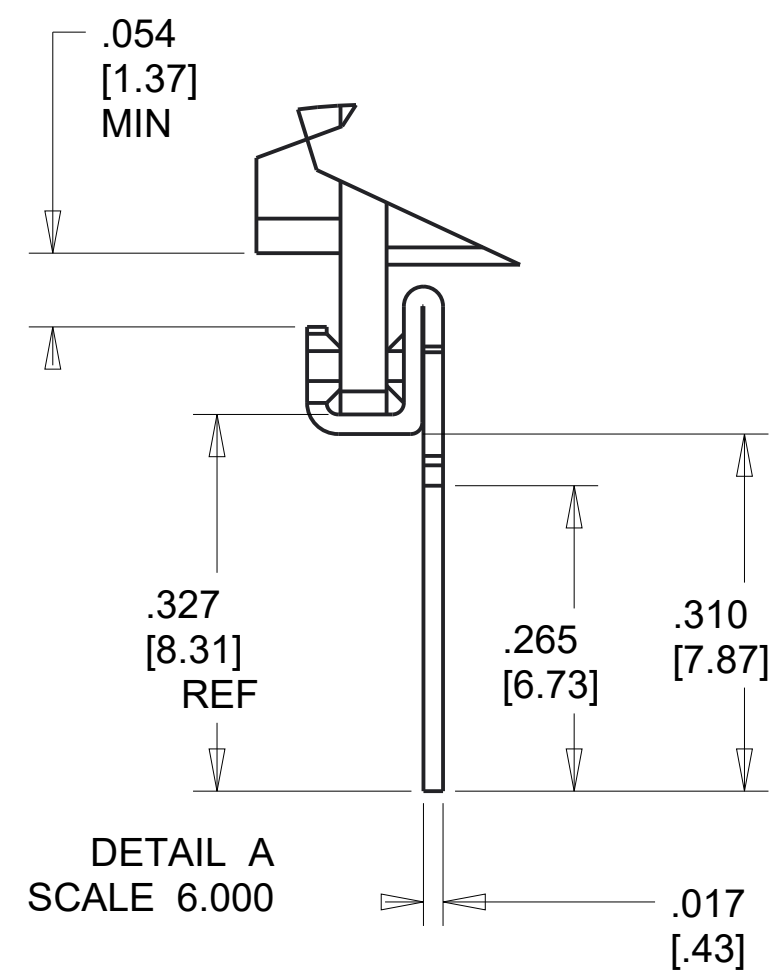

TOLERANCES - UNLESS OTHERWISE SPECIFIED	
.XX ± .01 [254]	
.XXX ± .005 [127]	
ANG. ±5°	

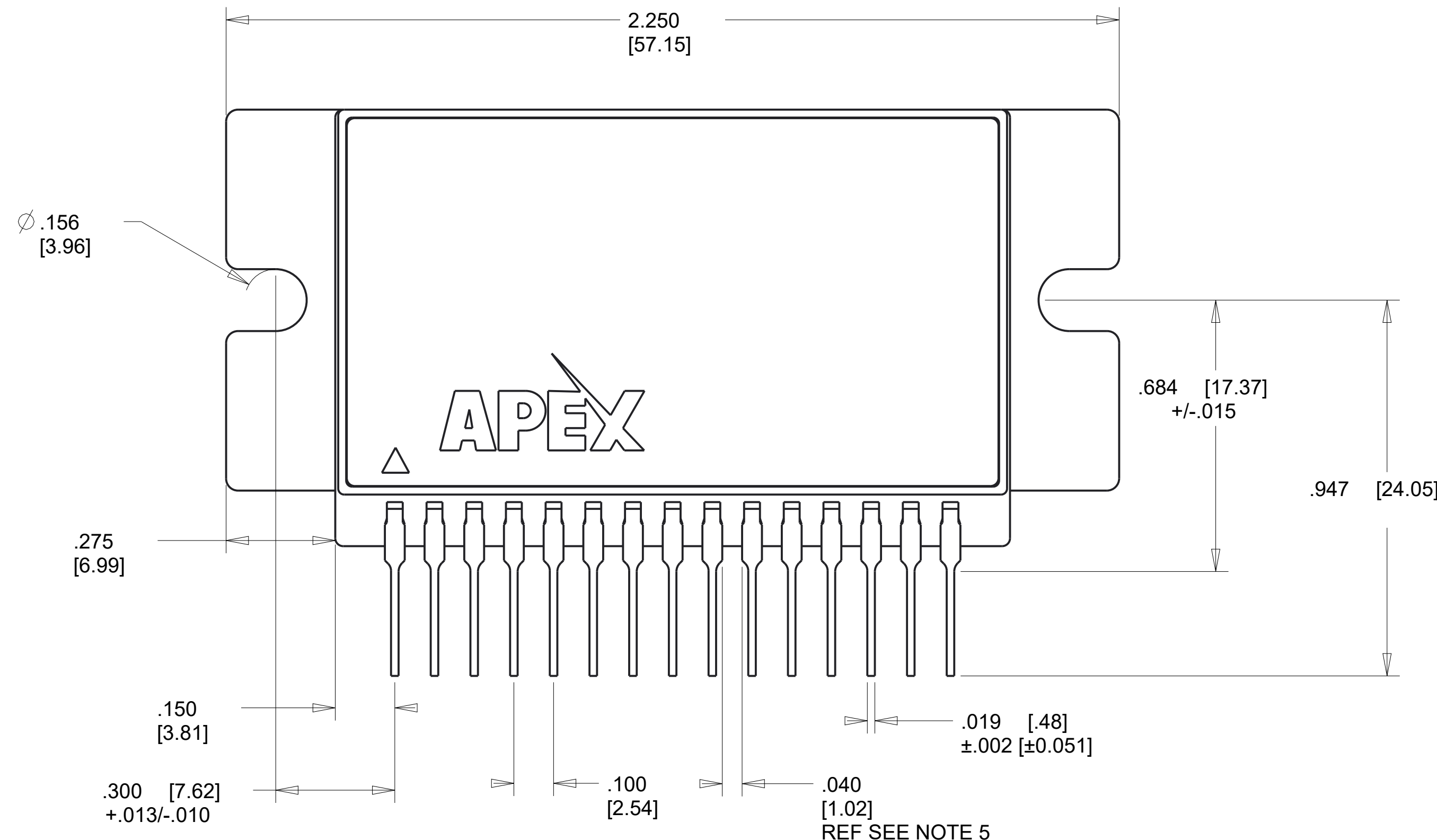
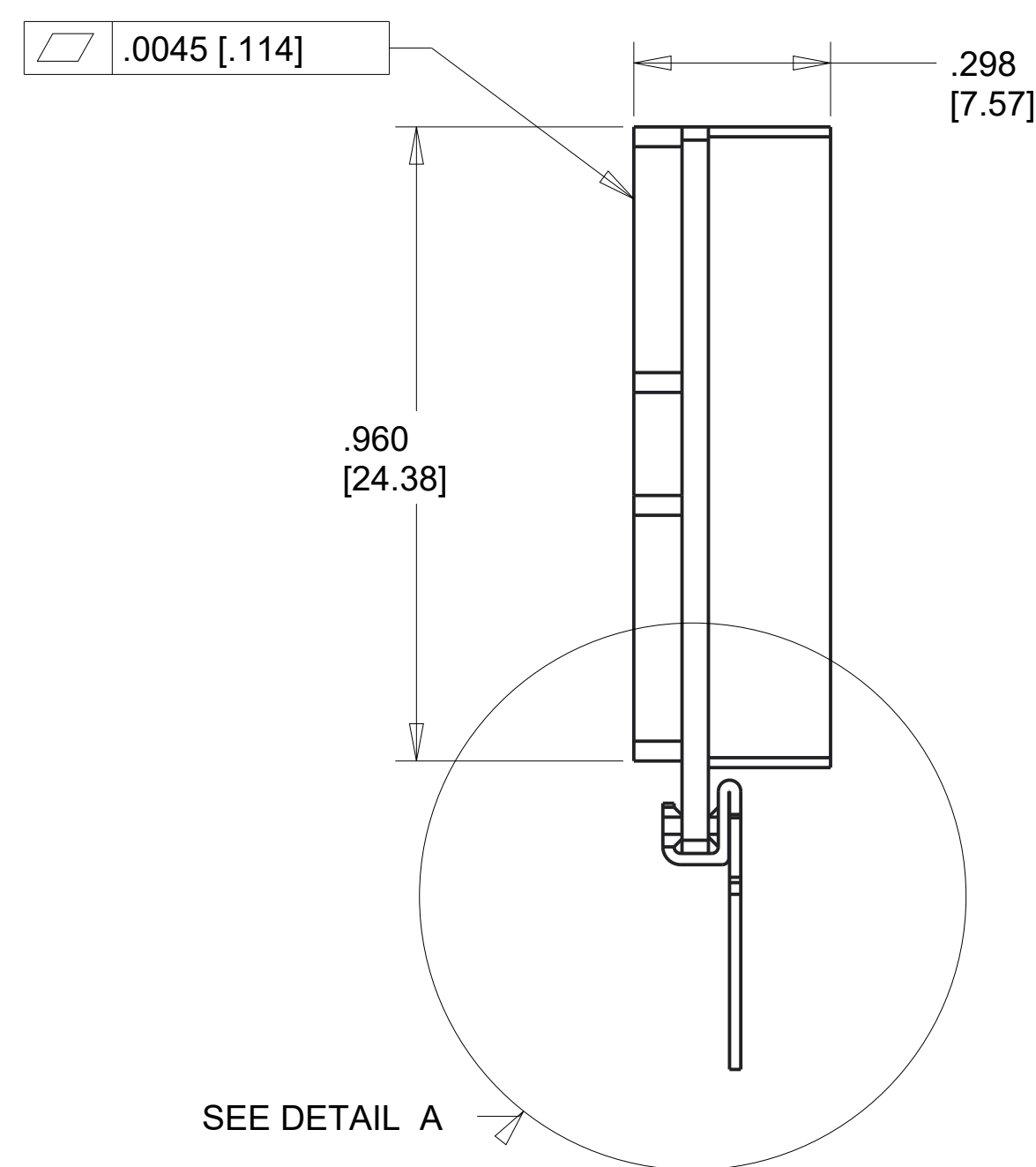
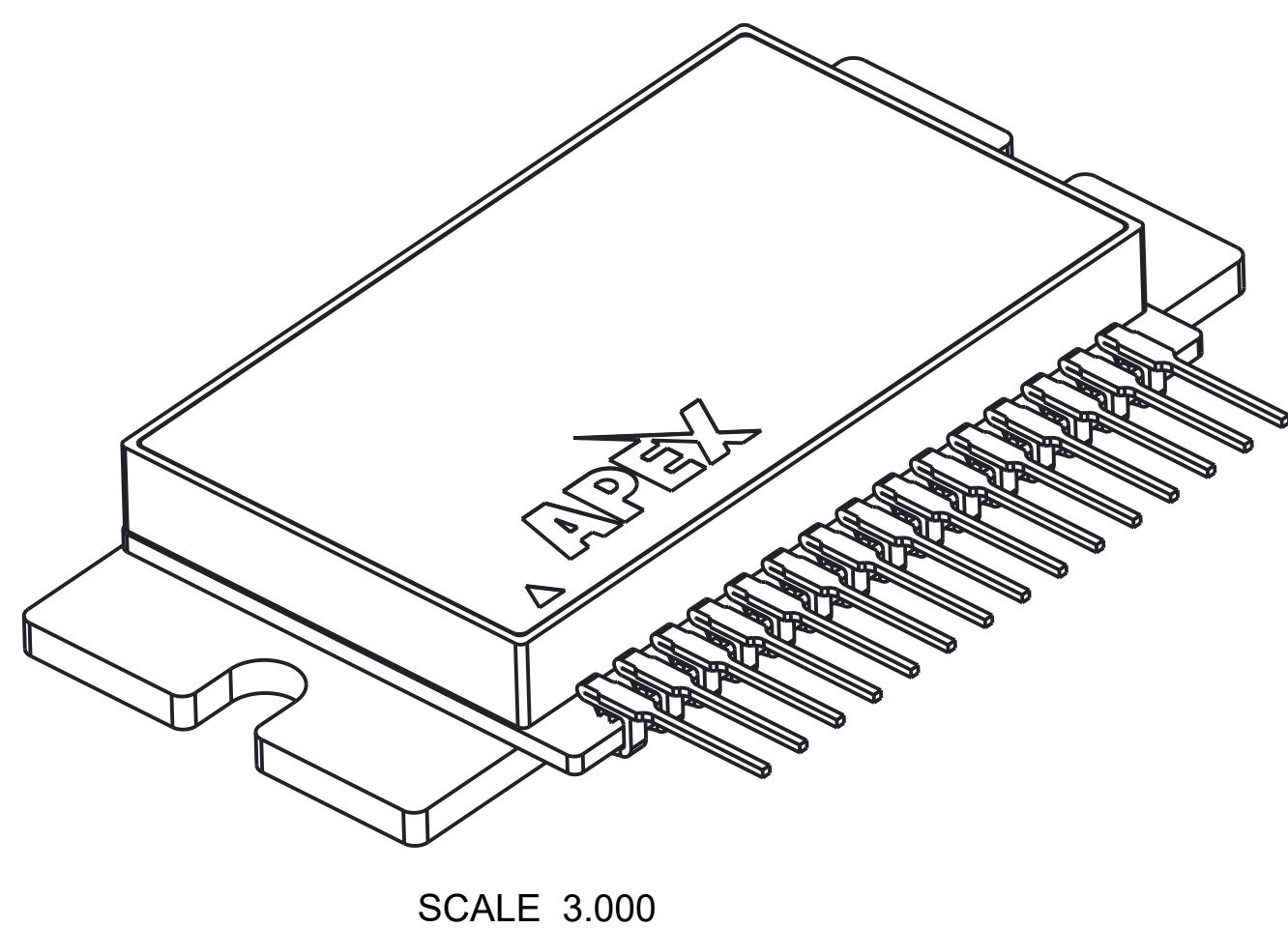

TITLE: 15-PIN POWER SIP				MODEL: LL	
SUBJECT: PACKAGE OUTLINE					
ENGINEER: MJM	DRAWN BY: MJM	DCA: 20079	SH. 1	OF 1	FILENAME: LL
				REV: B	DATE: 4/20/20